

SCHALTHEBEL

Gear lever | Pedale cambio | Sélecteur repliable | Palanca de cambios

Art.-Nr: 26280-101

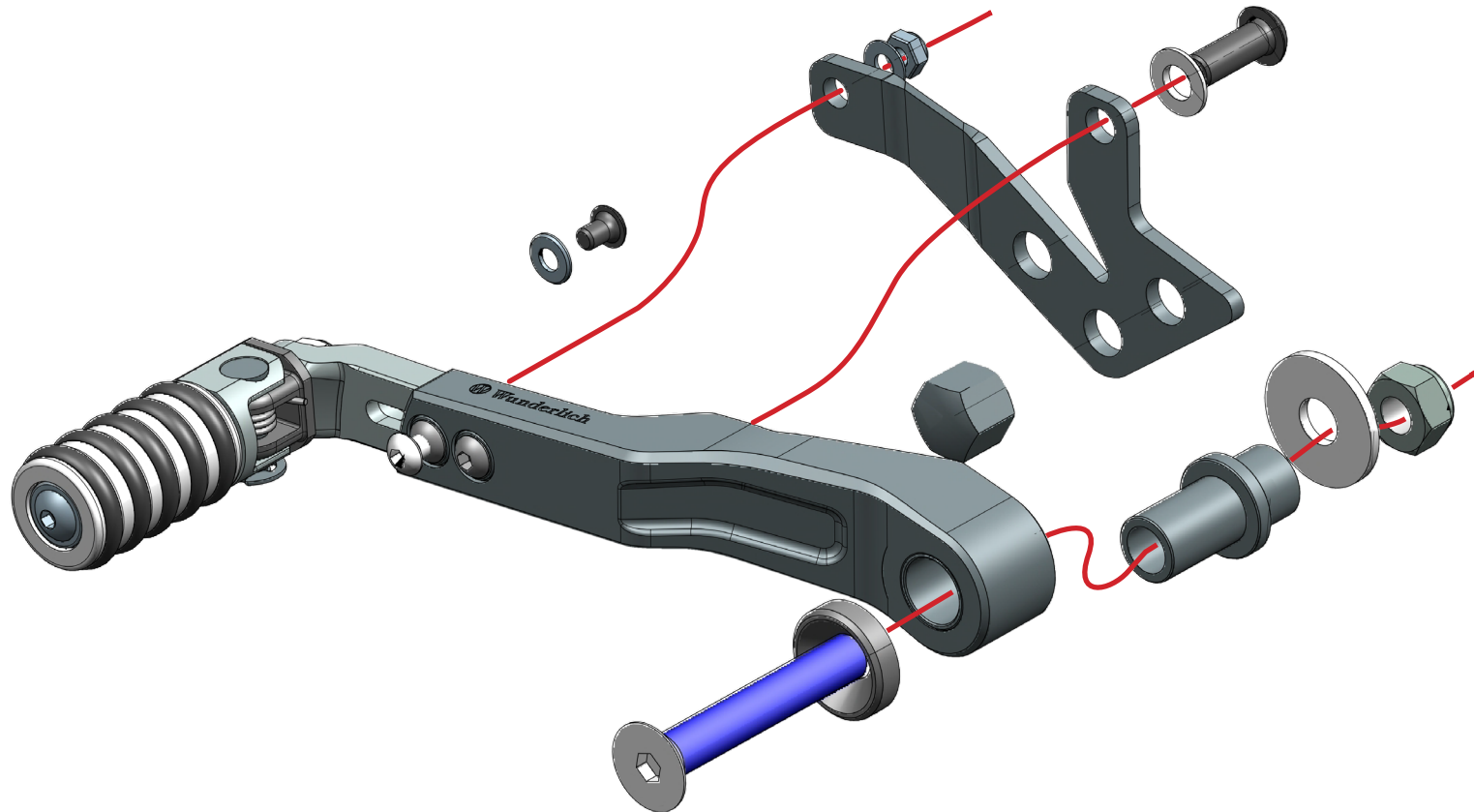

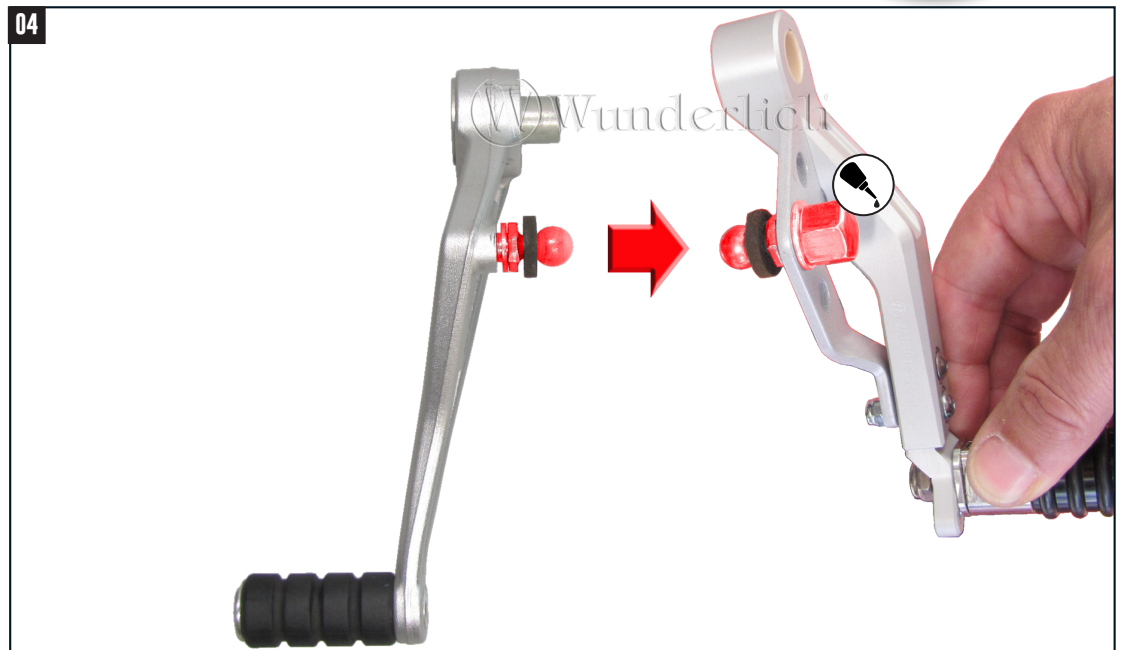
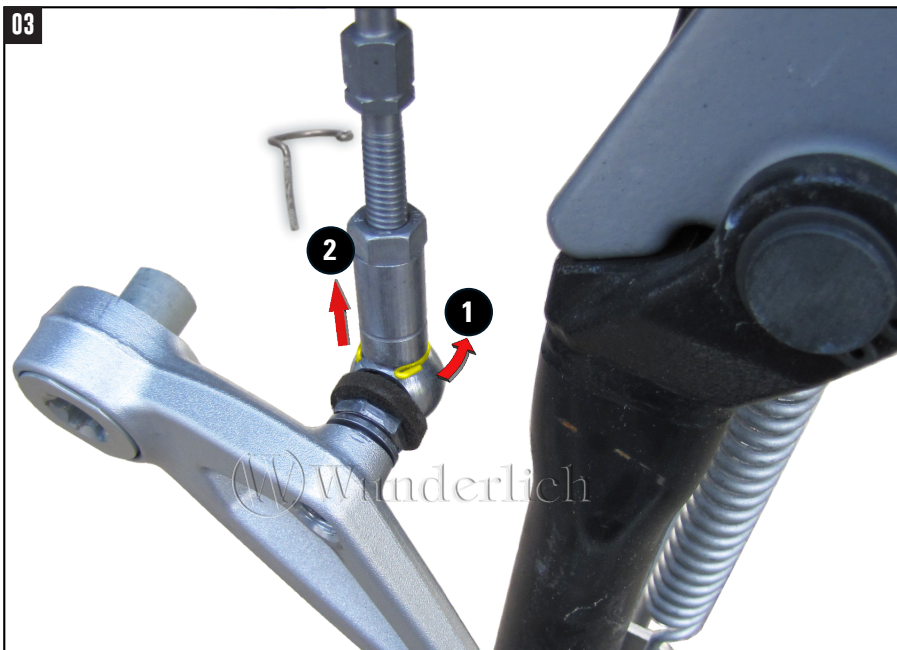
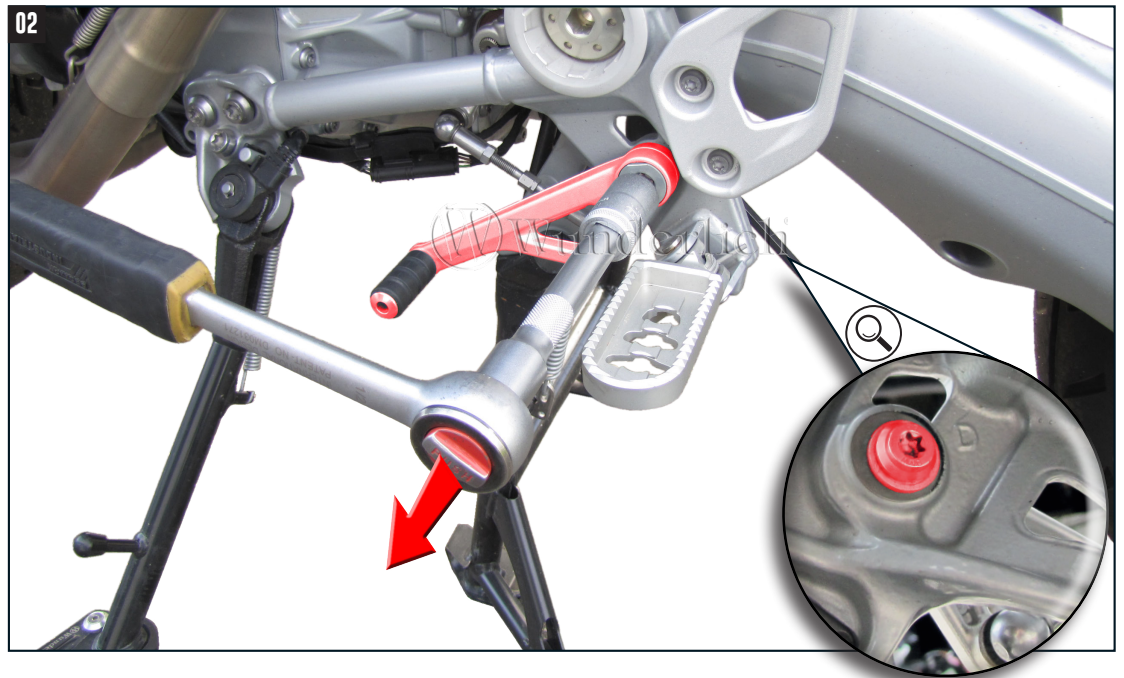
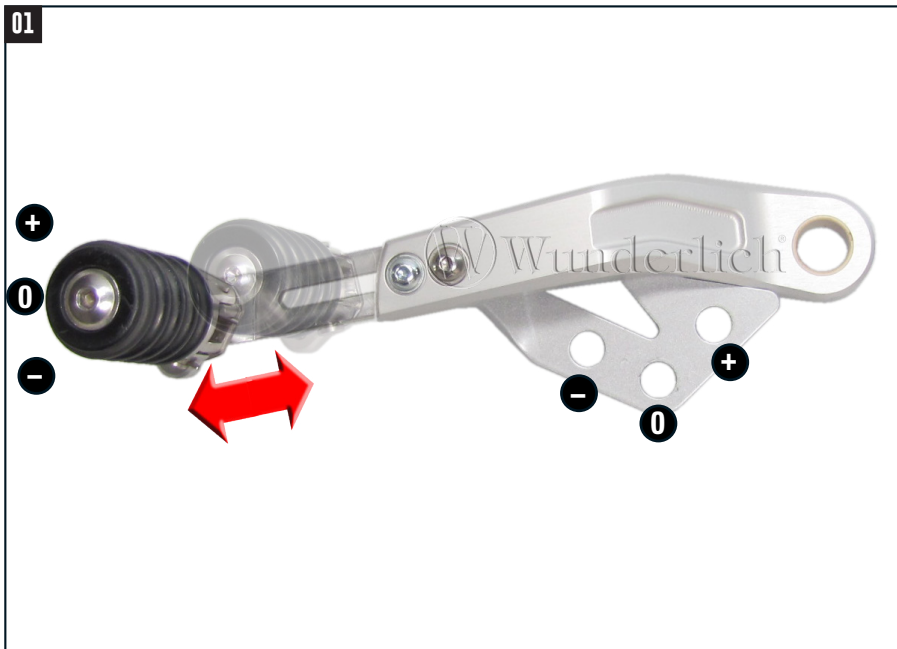

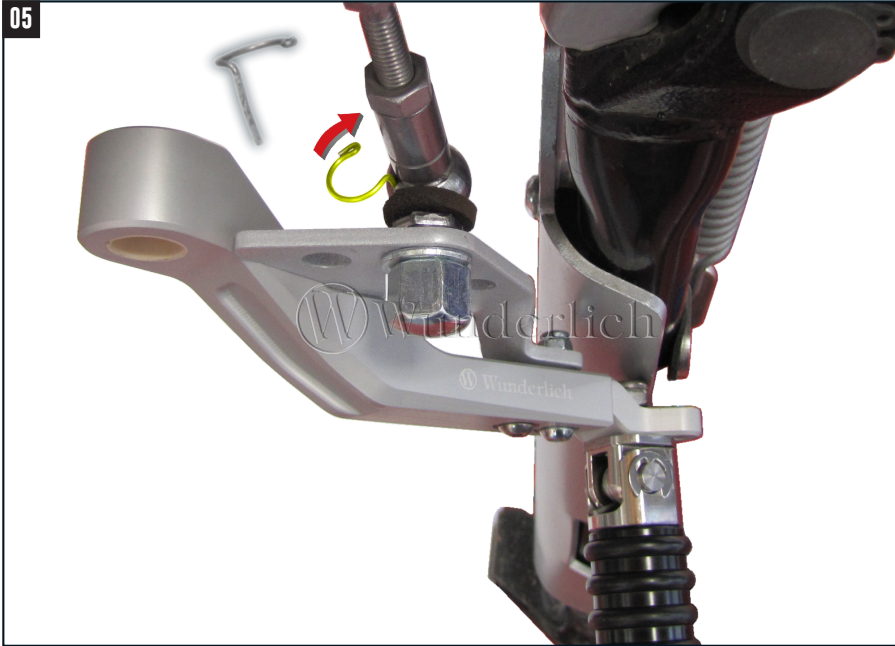

! Schalthebel über Schaltgestänge und Bohrungen +/- einstellen, alle Schrauben festziehen und einkleben!
 Adjust the gear lever via shift linkage and bores +/-, tighten all screws and paste into!

