

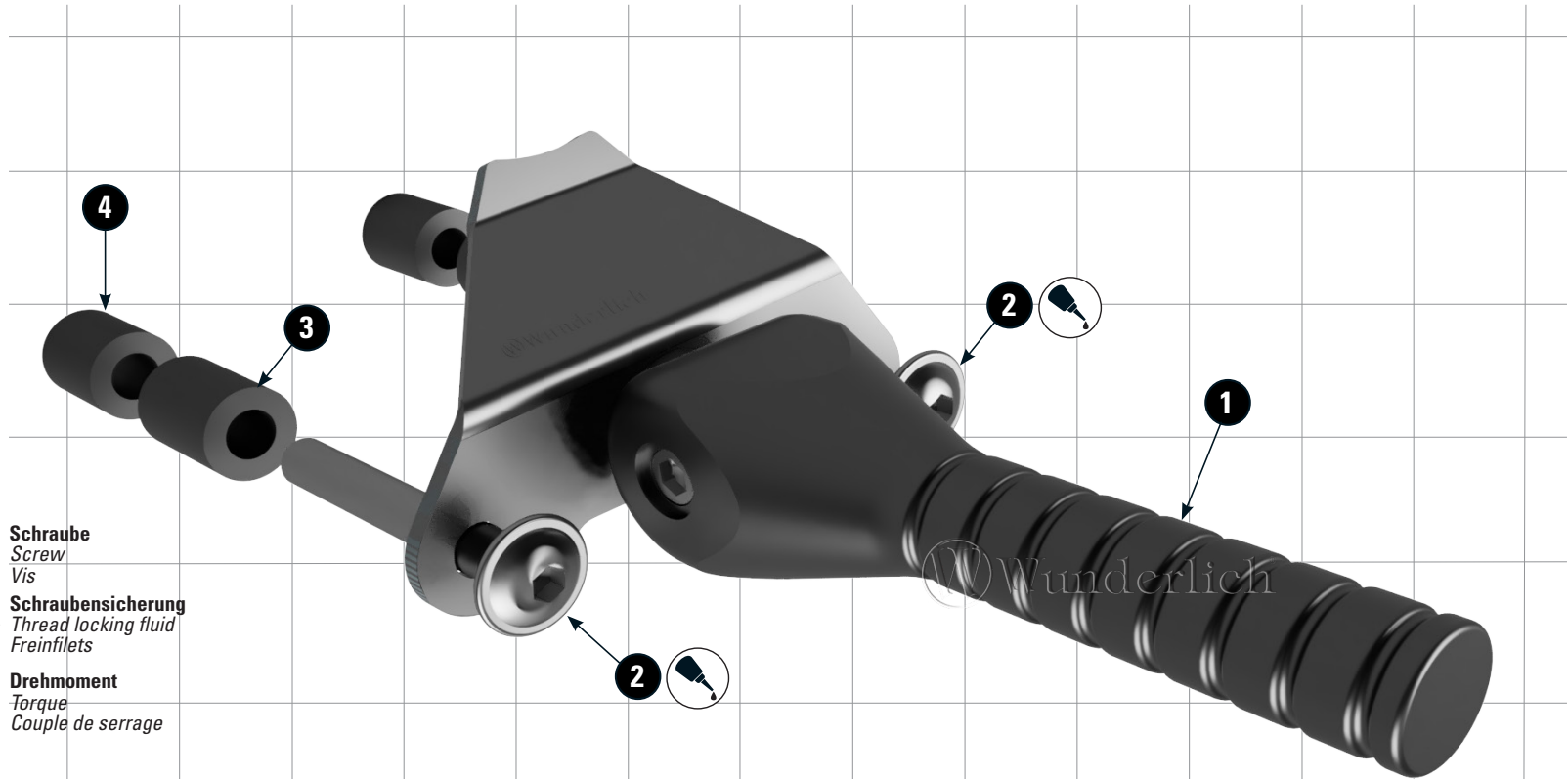



AUFBOCKHEBEL KLAPPBAR



Lifting handle foldable | Palanca plegable de elevación | Levier de cric repliable | Maniglia di sollevamento ribaltabile

Art.-Nr: 26190-102



LEGENDE/KEY/LÉGENDE

-  **Anbau Tip**
Fitting tip
Astuce de montage
-  **Achtung**
Attention
Attention
-  **Vergrößerung**
Magnification
Grossissement
-  **Montagepaste**
Fitting lubricant
Lubrifiant de montage

-  **Schraube**
Screw
Vis
-  **Schraubensicherung**
Thread locking fluid
Freiniflets
- M**
Nm **Drehmoment**
Torque
Couple de serrage

#	BEZEICHNUNG / DESCRIPTION	DE Die Farben der Abbildungen dienen nur der Veranschaulichung. EN The colors are for illustrating purposes only. FR Les couleurs utilisées sont à titre indicatif seulement.	DIN	ISO	MENGE AMOUNT
1	Aufbockhebel / Lifting handle				1
2	Linsenflanschschraube / lens head screw M8x55 (28Nm)		7381A2	7381A2	2
3	Hülse / sleeve (21mm)				2
4	Hülse / sleeve (18mm)				2
5	Lackschutzfolie / protection film				20cm
6	Gummipuffer / rubber buffer				2



DE Die 18mm Hülsen (Nr.4) werden nur in Verbindung mit unseren Kofferträgern benötigt.
EN The 18mm sleeves (No. 4) are only required in combination with our luggage carriers.
FR Les entretoises de 18mm (n° 4) sont nécessaires uniquement avec notre porte-bagage.

