

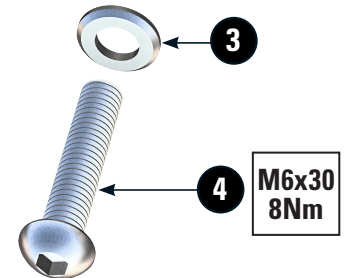

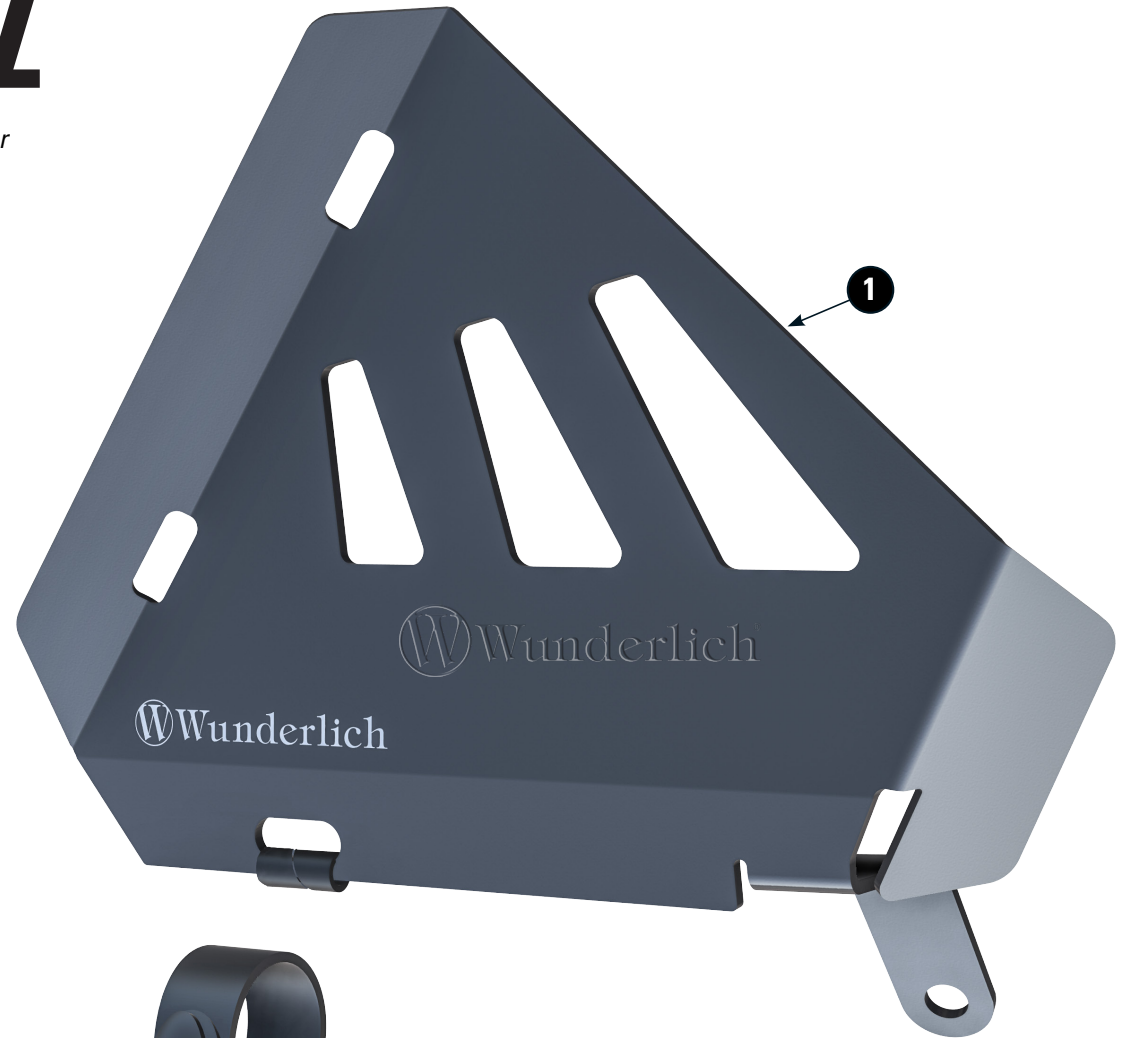

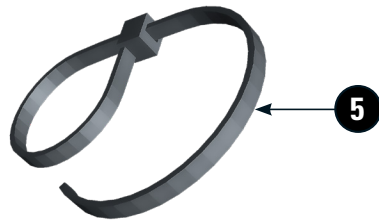

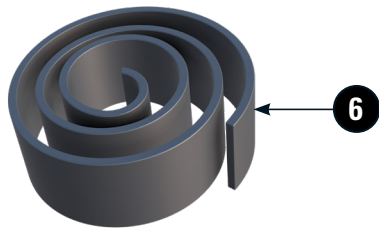

# ANLASSERSCHUTZ

Starter protection | Protection démarreur | Protección de arranque | Protezione Starter

Art.-Nr: 42980-00X

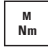

## LEGENDE/KEY/FILE LÉGENDE

-  **Anbau Tipp**  
Fitting tip  
Astuce de montage
-  **Achtung**  
Attention  
Attention
-  **Vergrößerung**  
Magnification  
Grossissement
-  **Montagepaste**  
Fitting lubricant  
Lubrifiant de montage
-  **Schraube**  
Screw  
Vis
-  **Schraubensicherung**  
Thread locking fluid  
Freiniflets
-  **Drehmoment**  
Torque  
Torque
-  **Reiniger**  
Cleaner  
Nettoyant



#	Bauteil component composant	DE Die Farben der Abbildungen dienen nur der Veranschaulichung. EN The colors are for illustrating purposes only. FR Les couleurs utilisées sont à titre indicatif seulement.	DIN	ISO	Menge quantity quantité
1	Anlasserschutz / Starter protection				1
2	Gummischelle / Rubber clamp				1
3	U-Scheibe / Washer M6		125	7089	1
4	Linsenkopfschraube / Lens head screw M6x30		7380	7380	1
5	Kabelbinder / Zip tie				2
6	Moosgummi / Foam rubber				1

