

ZWEIKLANGHUPE

Two-tone horn | Klaxon à deux tons | Corno bicolore | Bocina de dos tonos

Artikel.-Nr: **11830-00X**

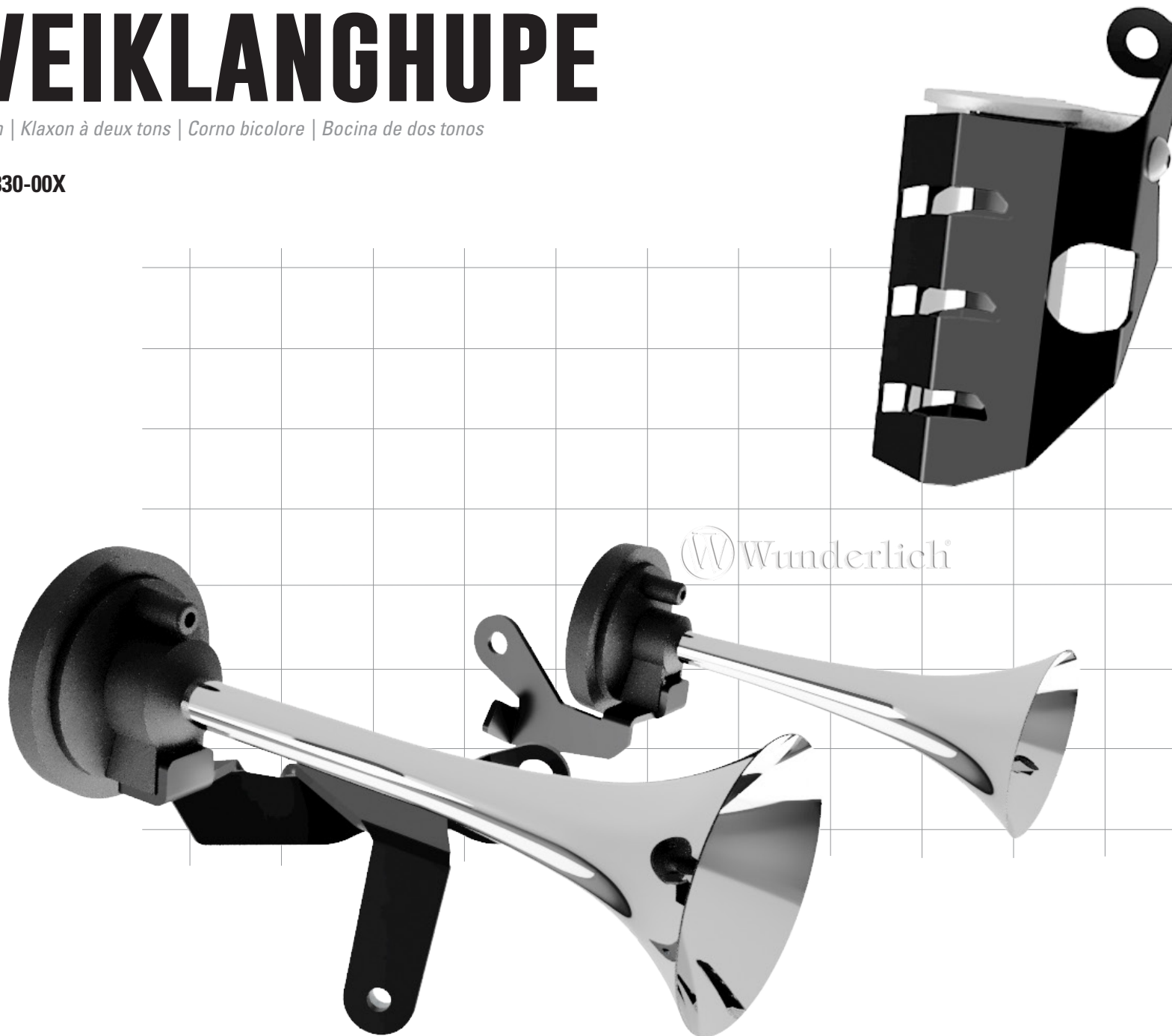

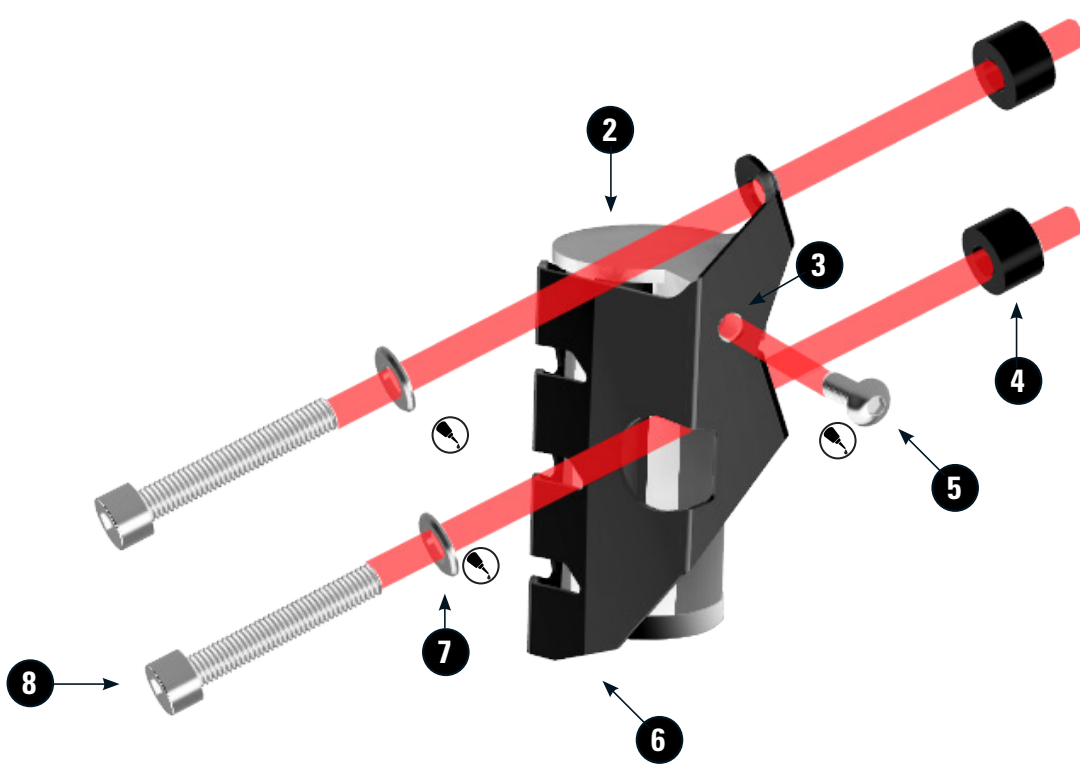





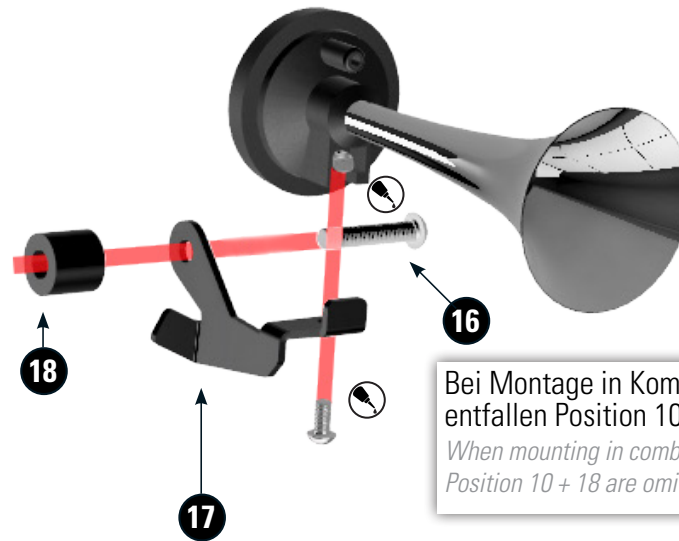
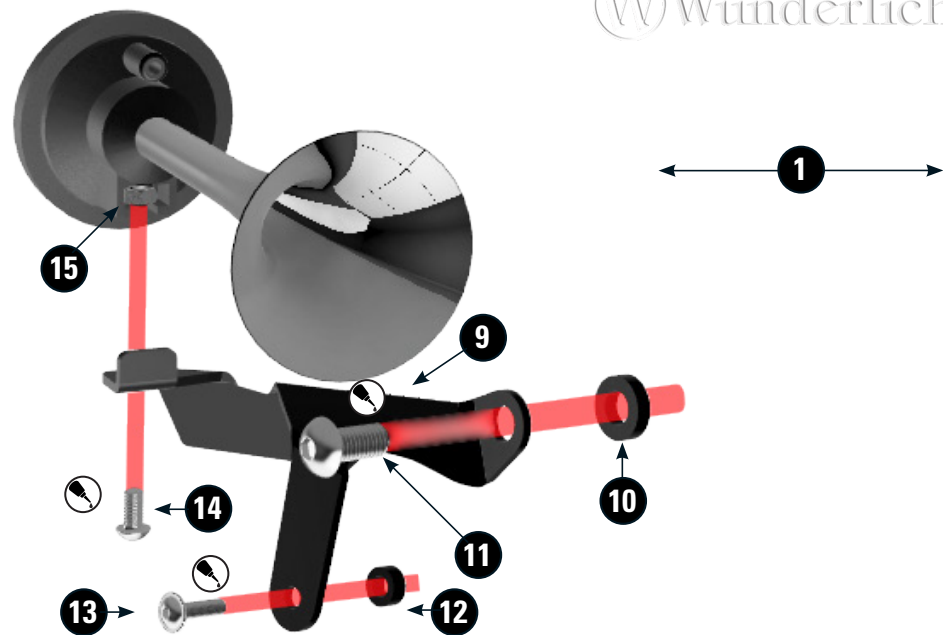



#	BEZEICHNUNG / DESCRIPTION	DE EN FR	Die Farben der Abbildungen dienen nur der Veranschaulichung. The colors are for illustrating purposes only. Les couleurs utilisées sont à titre indicatif seulement.	DIN	ISO	MENGE QUANTITY
1	Zweiklanghupe / Two-tone horn					1
2	Luftkompressor / Air compressor					1
3	Sechskantmutter / Hexagon Nut M8					1
4	Hülse / Sleeve D=22mm d=10.5mm l=14mm					2
5	Linsenflanschschaube / Lense flange screw M8x20			7381A2		1
6	Kompressorhalter / Air compressor bracket					
7	Unterlegscheibe / Washer M10			125A2		2
8	Zylinderkopfschraube / Cylinderhead screw M10x60			912Z 10.9		2
9	Halter rechts / Holder right					1
10	Hülse / Sleeve D=20mm d=10.5mm l=5mm					1
11	Linsenflanschschaube / Lense flange screw M10x20			7381A2		1
12	Hülse / Sleeve D=12mm d=6.5mm l=5mm					1
13	Linsenflanschschaube / Lense flange screw M5x18			7381A2		1
14	Linsenflanschschaube / Lense flange screw M6x12			7381A2		2
15	Sechskantmutter / Hexagon Nut M6					1
16	Linsenflanschschaube / Lense flange screw M8x40			7381A2		1
17	Halter links / Holder left					1
18	Hülse / Sleeve D=22mm d=10.5mm l=20mm					1

Wunderlich

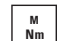

LEGENDE/KEY/FILE LÉGENDE

-  **Anbau Tipp**
Fitting tip
Astuce de montage
-  **Achtung**
Attention
Attention
-  **Vergrößerung**
Magnification
Grossissement
-  **Montagepaste**
Fitting lubricant
Lubrifiant de montage
-  **Schraube**
Screw
Vis
-  **Schraubensicherung**
Thread locking fluid
Freiniflets
-  **Drehmoment**
Torque
Torque
-  **Reiniger**
Cleaner
Nettoyant

Bei Montage in Kombination mit Motorschutzbügel 18100-00X
entfallen Position 10 + 18
When mounting in combination with motor protection bar 18100-00X
Position 10 + 18 are omitted

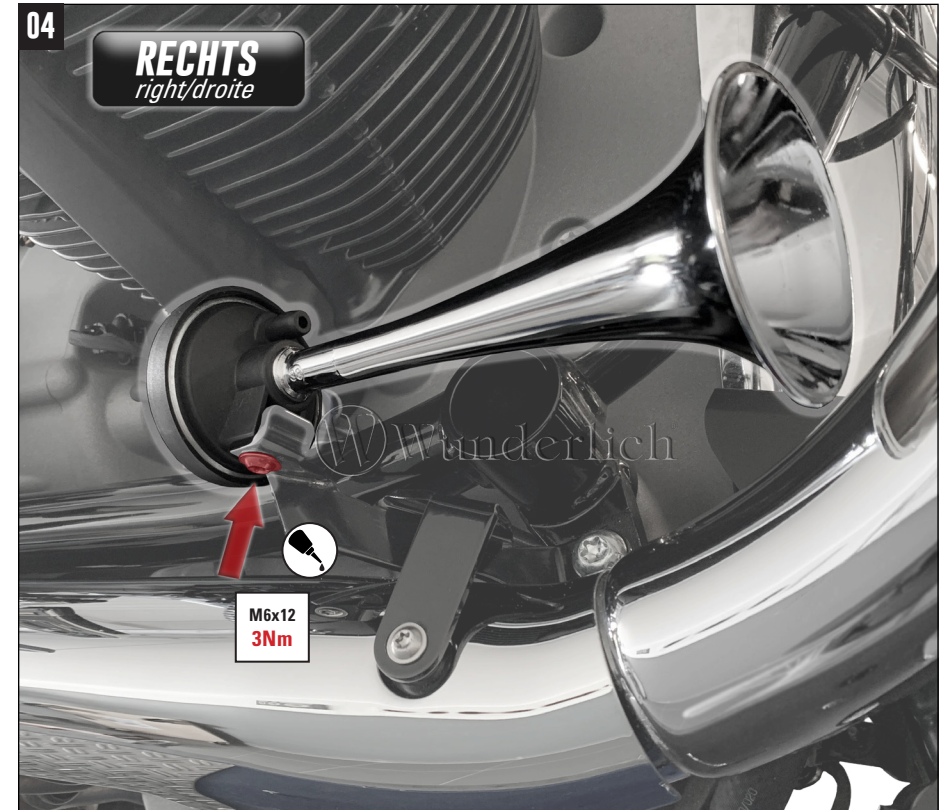
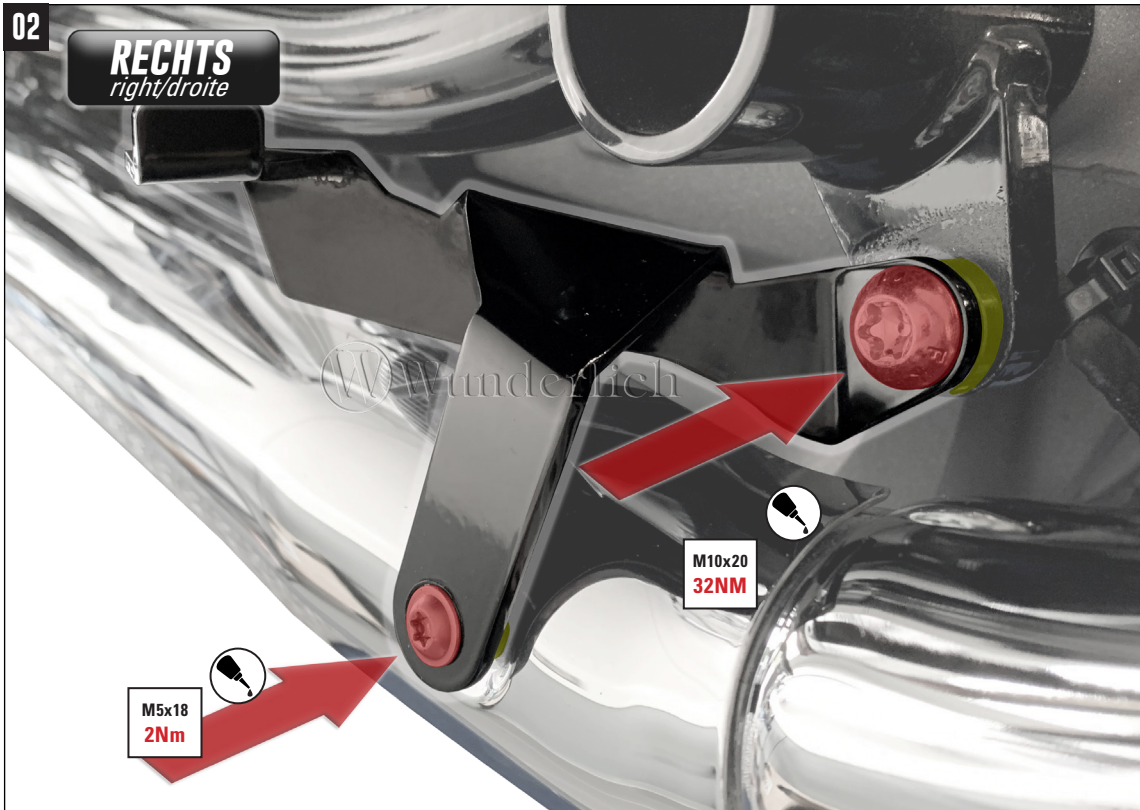

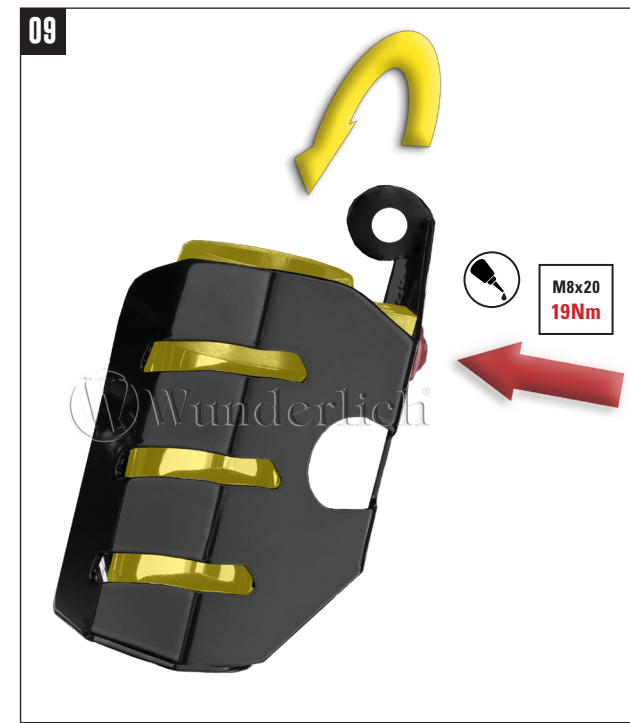
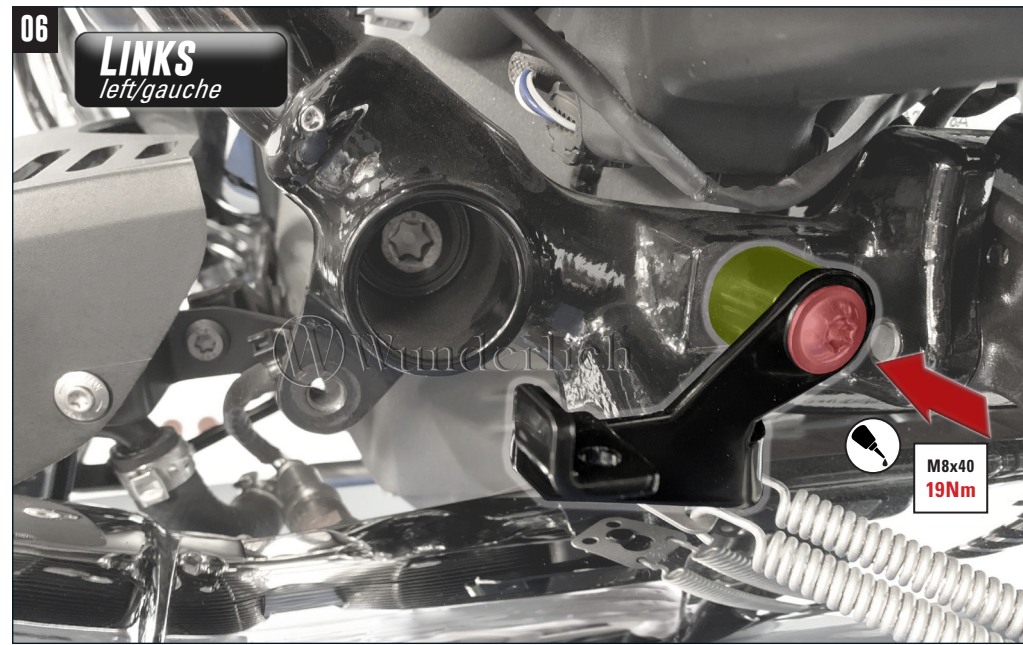

10

RECHTS
right/droite

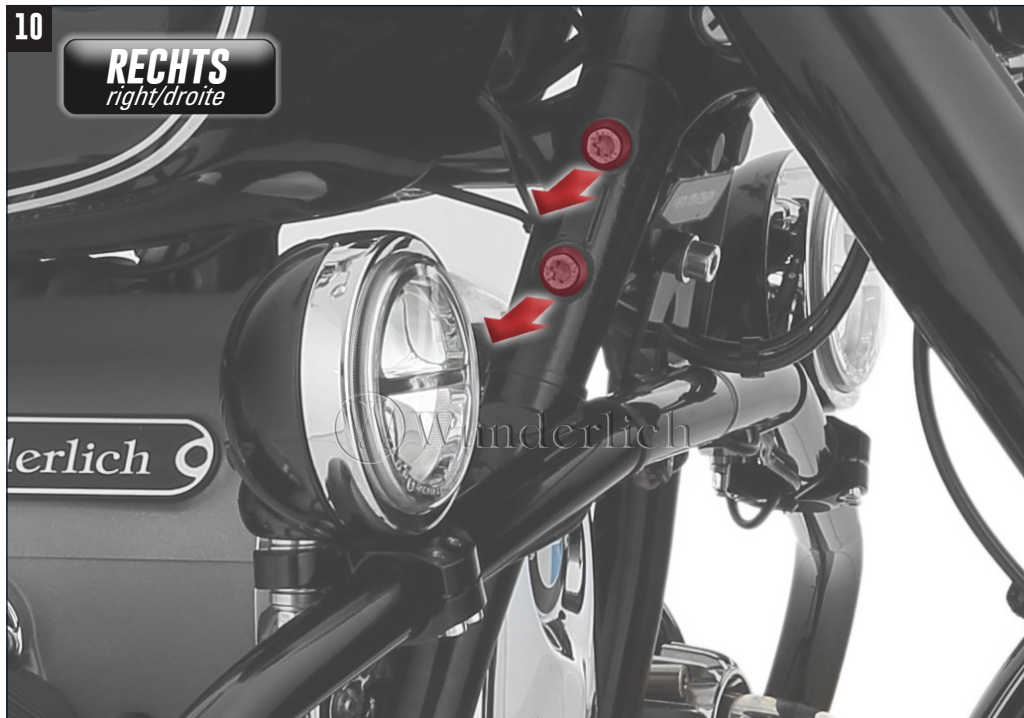

11

RECHTS
right/droite

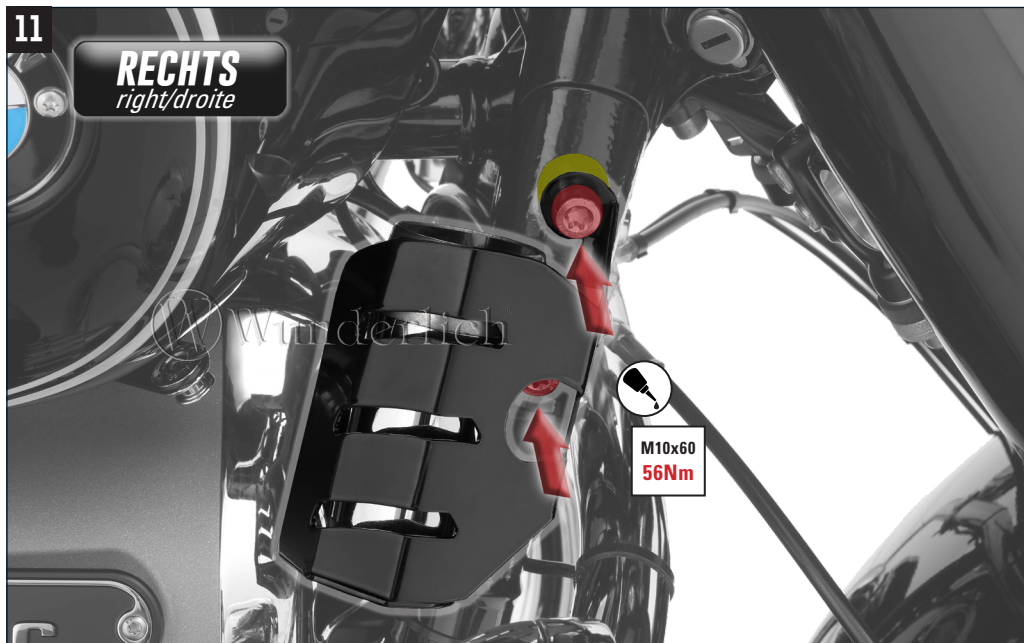

12

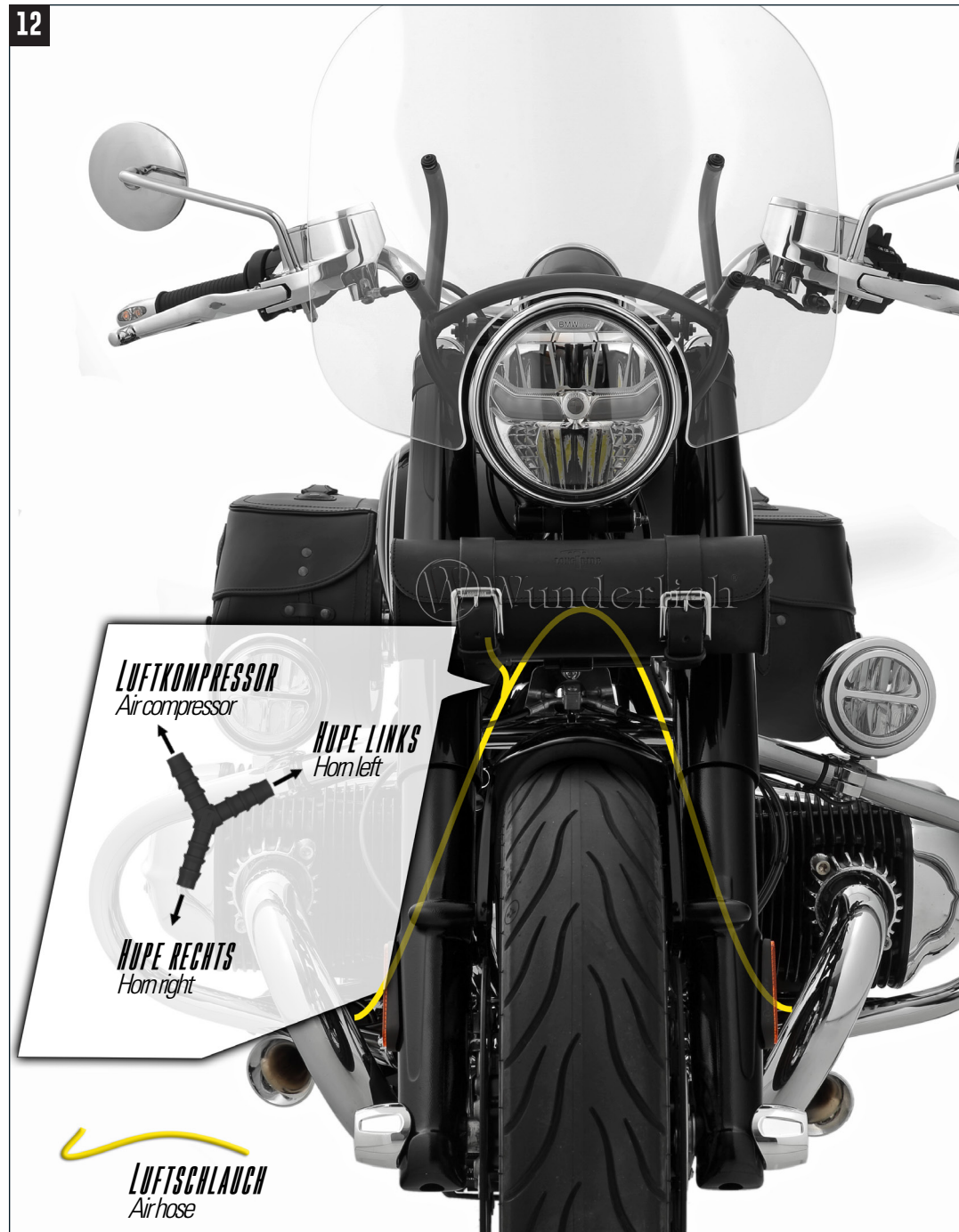

LUFTKOMPRESSOR
Air compressor

HUPE LINKS
Horn left

HUPE RECHTS
Horn right

LUFTSCHLAUCH
Airhose



DE ANSCHLUSSARBEITEN BEI ABGEKLEMMTER BATTERIE AUSFÜHREN

EN Carry out connection work with the battery disconnected.

FR Effectuez les travaux de raccordement avec la batterie débranchée.

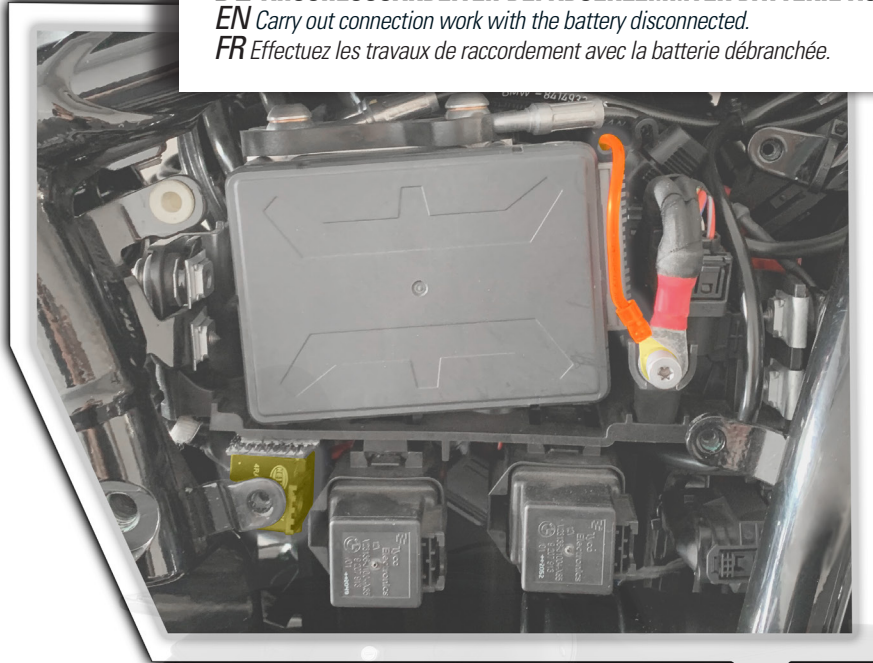

MASSEVERBINDUNG
Ground connection

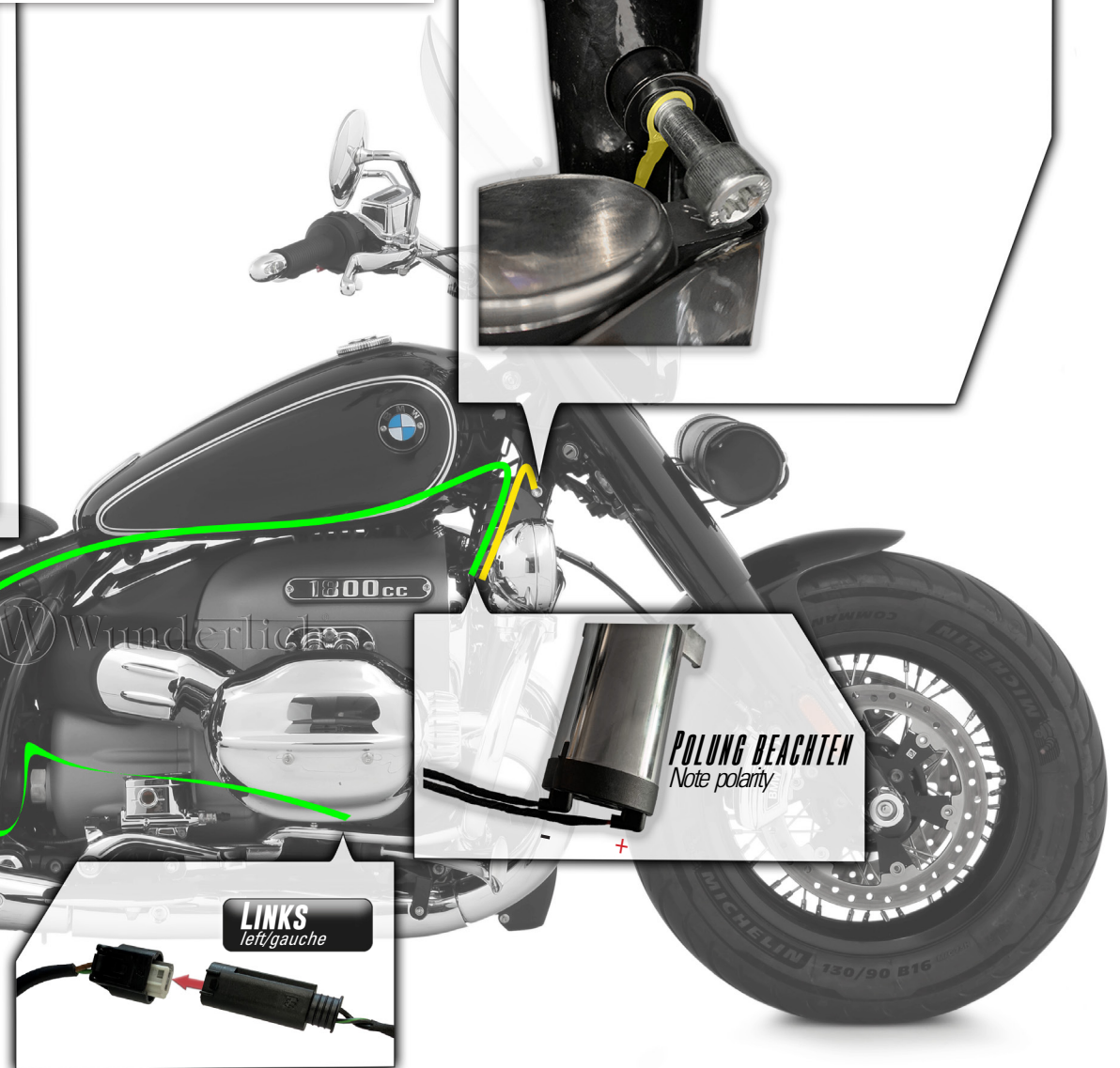

POLUNG BEACHTEN
Note polarity



LINKS
left/gauche